

WHITES

Thinking Outside

SCREEN UP

Slat Screening System

did you know?

Screen Up can be built freestanding or mounted onto an existing wall. Both systems fit together perfectly to create an integrated privacy screen.

A better way to build screens!

Build your own privacy screens quickly and easily. Screen Up captures the natural beauty of timber with professional looking results.

securely mounts to posts, walls, fences...

unique spacers slot into place to provide even spacing

slats fit neatly into channel for professional looking results, every time

PRODUCT SELECTION GUIDE

- 1 Pick a fixing option**
Freestanding or Wall Mounted
- 2 Select a length**
1.1 metre or 2.0 metre*
- 3 Choose your slats**
16mm or 19mm widths*

WALL MOUNTED

Available for 16mm or 19mm width slats

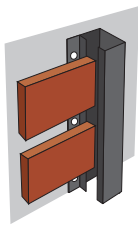

Side Fix

Side of channel is fixed to wall.

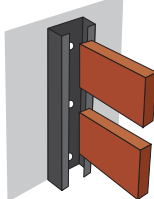

Rear Fix

Rear of channel is fixed to wall.

FREESTANDING

*2.0m lengths for 19mm width slats

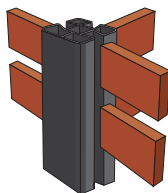

Corner Post

Three-way corner or end post.

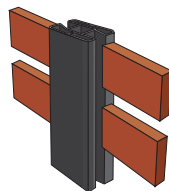

Joiner Post

Two-way joiner or end post.

WALL MOUNT INSTALLATION GUIDE

Choose from Rear Fix or Side Fix to easily create privacy screens between walls and posts. Also use for decorative screens across the face of walls.

Measure & mark up

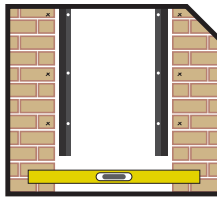

Install Screen Up channels

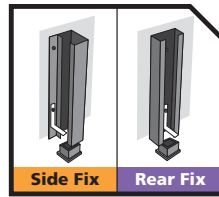

Insert slats & spacers

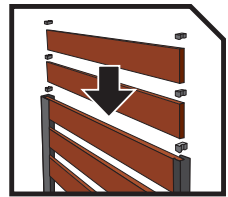

FREESTANDING INSTALLATION GUIDE

Build complete privacy screens that span longer distances without wall or post support. Anchors securely to the ground for a complete freestanding solution.

Measure & position posts

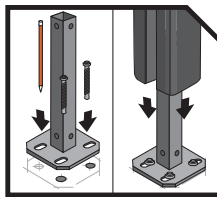

Insert slats & spacers

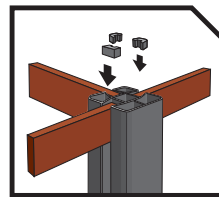

Lock in & brace slats

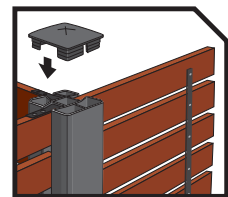

Complete installation instructions included with each product and at www.screenup.com.au

3-Way Corner

Square post for multiple configurations to suit you

Cover Strip

Converts to brace strip for screens wider than 1200mm

2-Way Joiner

Connect multiple screens to form a long wall

Cut to Size

2m high channel can be cut to size

Any Surface

Surface mount to decks & paving or set in concrete

Integrated

Fits perfectly with wall-mounted Screen Up

Freestanding

Stands on its own without wall support



Watch our
Screen Up
video here

www.whitesgroup.com.au/screenup

SLAT CALCULATOR

	SCREEN UP HEIGHT	
SLAT WIDTH	1.1m	2.0m
70mm	12	22
90mm	10	18